

BPOWER®

Bpower SUPREME GTZ14S

GEL 12V - FACTORY ACTIVATED

Parameters

Voltage	12V
Capacity	11,2Ah
Current	230A

Dimensions

Length	150mm
Width	88mm
Height	110mm

Weight

With electrolyte	3,52kg
------------------	--------

Case Features

Cell configuration	Left+
Cell layout	11

Technology

Technology	CA/CA
Separator	AGM
Recommended charging current	1,12A
Mounting Angle	360°



Type of terminal

Cell configuration

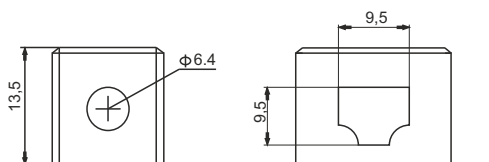

Front View

Side View

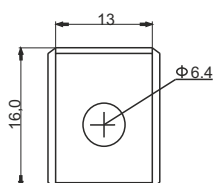

Top View

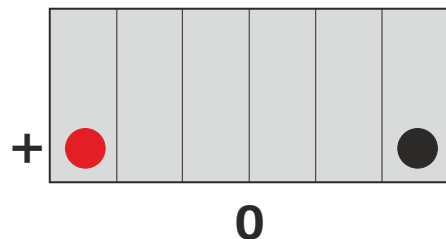

The date of issue of catalog card: 03/2018