

BPOWER[®]

Bpower SUPREME GTZ10S

GEL 12V - FACTORY ACTIVATED

Parameters

Voltage	12V
Capacity	8,6Ah
Current	190A

Dimensions

Length	150mm
Width	88mm
Height	93mm

Weight

With electrolyte	2,90kg
------------------	--------

Case Features

Cell configuration	Left+
Cell layout	11

Technology

Technology	CA/CA
Separator	AGM
Recommended charging current	0,86A
Mounting Angle	360°



Type of terminal

Cell configuration

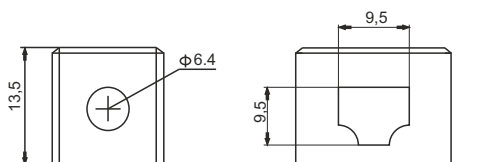

Front View

Side View

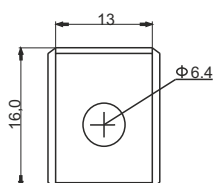

Top View

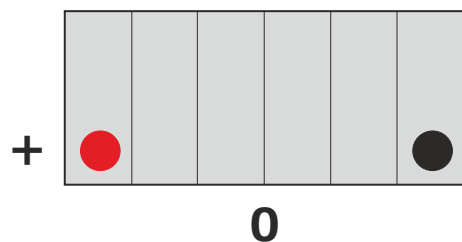

the date of issue of catalog card: 03/2018